

Assembly Instructions

1. Connect straight tubes together to create the bottom square. Vertical tubes will attach to the bottom square on a vertical connector.
2. Making sure the female to female tubes are assembled above each other, connect straight tubes to the corner and the verticals to complete the frame.
3. Install light block liner. This will remove shadowing of hardware if the banner is a light solid color.
4. Separate the inside and outside sections of the banner to expose the bottom seam. Match vertical graphic seams up with a corner of the square. Pull the inside section up to hold it in place while zipping. Start the zipper at the "tail" and pull the outer section up while working the zipper around the frame. Work to keep the zipper evenly aligned along the top of the tube.
5. To finish the zipper, tuck the "tail" of the zipper inside the banner before closing.
6. After installing fabric, smooth the fabric away from the corner verticals at the bottom and top of the frame.
7. Attach the ends of the cable harness to the hang points in preparation for hanging.

Finished Structure

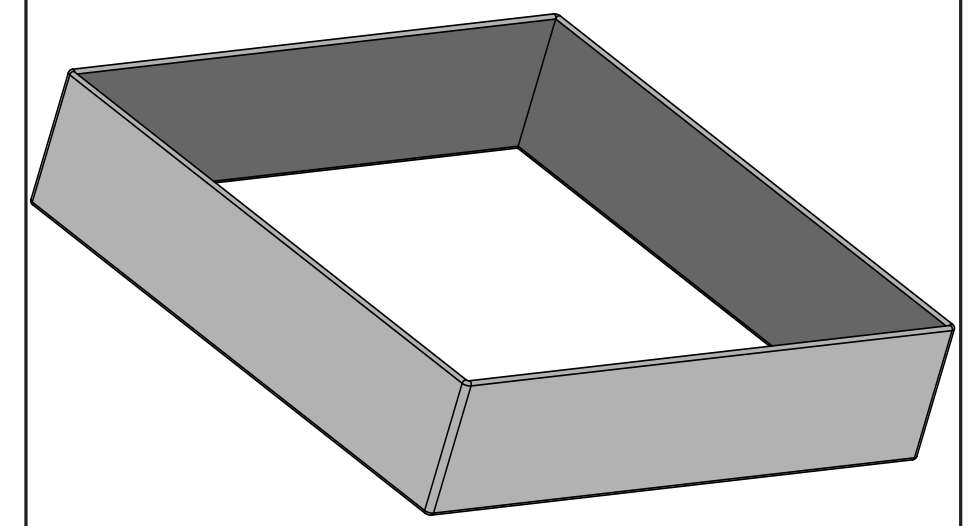

SkyFlyer™ Hanging Structure

Square

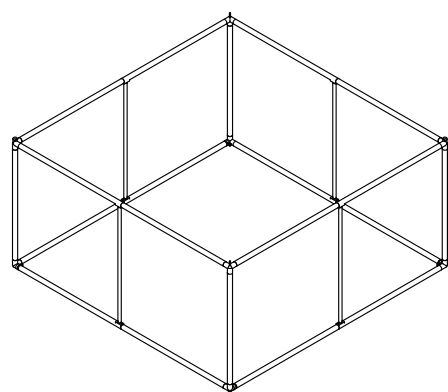

Square/Rectangle

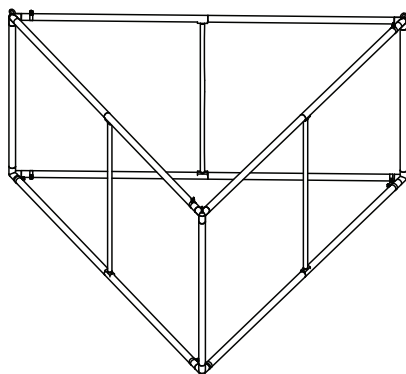

Triangle

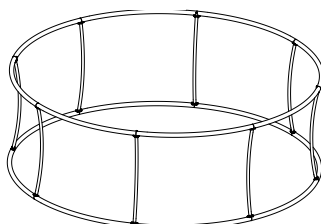

Ring Frame

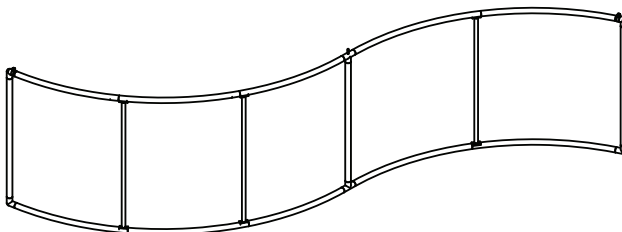

Sine Wave

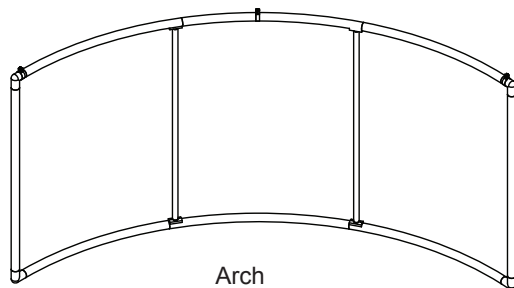

Arch

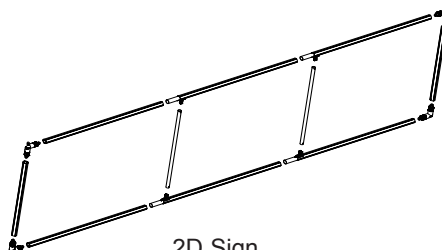

2D Sign

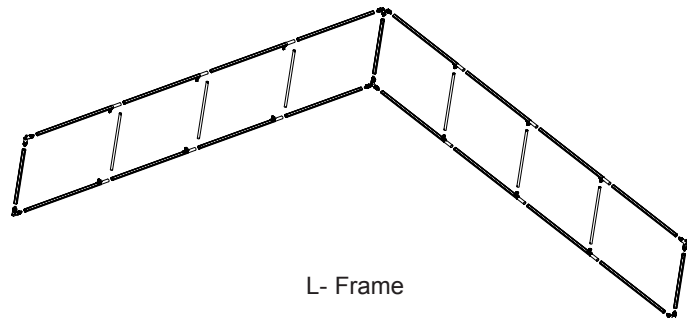

L- Frame

CORNERS:

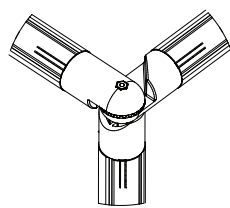

3-WAY (90°)

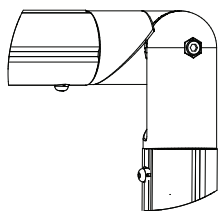

2-WAY (90°)

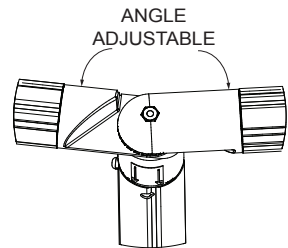

3-WAY ADJUSTABLE

Angle (45, 60, 75, 90, 105, 120, 135, 150, 165, 180 degrees)

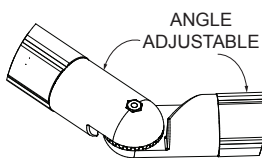

2-WAY ADJUSTABLE

Angle (45, 60, 75, 90, 105, 120, 135, 150, 165, 180 degrees)

TUBES:

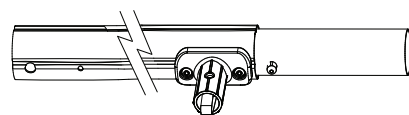

HORIZONTAL
MALE / FEMALE
(2 SNAP BUTTON HOLES)

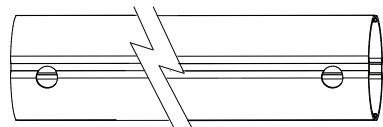

FEMALE / FEMALE
(2 SNAP BUTTON HOLES)

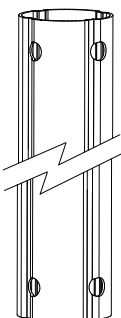

VERTICAL
CORNER TUBES
(4 SNAP BUTTON HOLES)

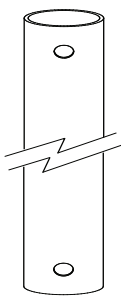

VERTICAL
MID TUBE
(SMALL TUBES)

CONNECTIONS:

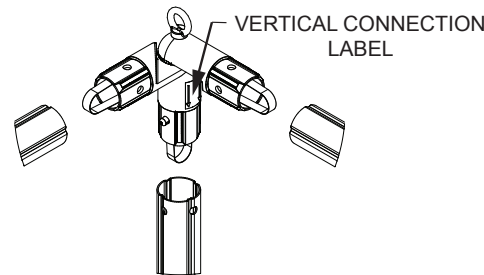

CORNER

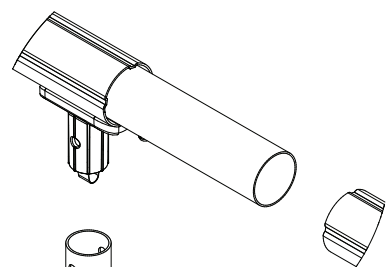

VERTICAL

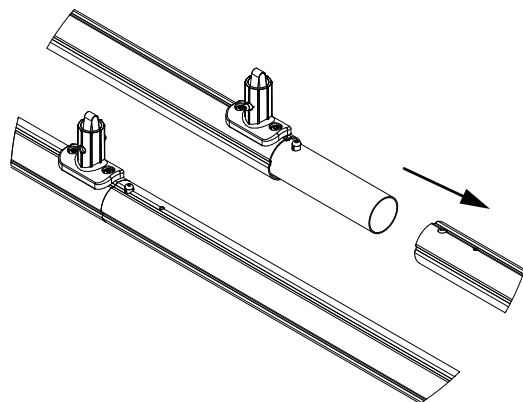

MALE TO FEMALE

HANGING:

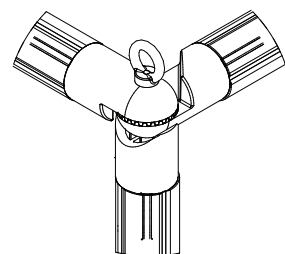

CORNER

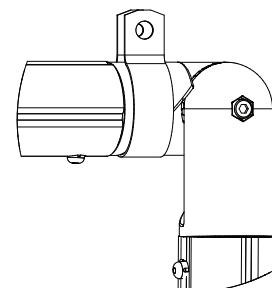

HANGING CLAMP

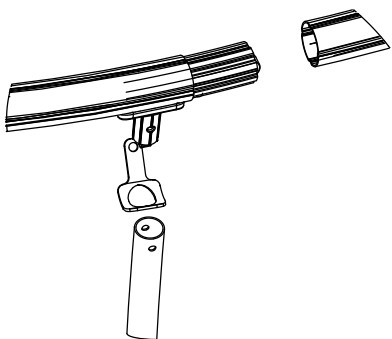

HANGING CLAMP
(RING)